



# TRASH TALK

Learn All about Bridgewater's Waste Services

Supplement to The Current - Fall 2025

## Weekly Residential Trash Service

### When will Waste Management come to my house?

Waste Management (WM) has divided the Town in half. Your trash will be collected on Monday or Tuesday. All items must be placed at the curb no later than 6 am on the day of collection. After collection, any carts used for trash should be removed no later than 7 am the next morning.



### Our family produces a lot of trash. What is the monthly fee for a second cart?

You can opt in for a second cart at any time for an additional monthly fee of \$1.00 on your utility bill. Complete the form at [bridgewater.town/2ndcart](http://bridgewater.town/2ndcart) or call B-Connected at (540) 908-4212.

### Where do I place my cart for refuse collection?

Put your cart curbside, in front of your home. Please allow three feet of clearance between objects and your cart. This allows for the automated arm the space needed to grab and dump the cart.

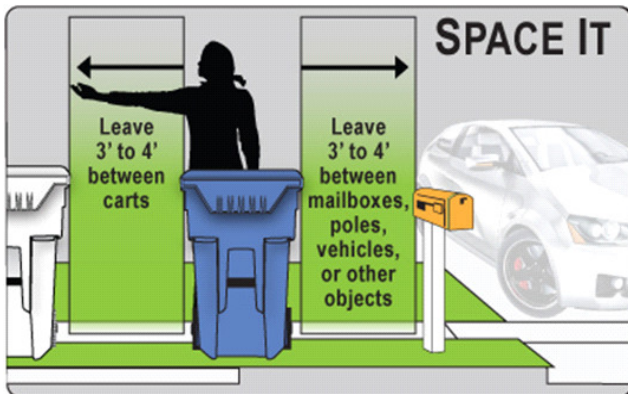

### The 96-gallon cart is too large. Do I have another option?

Yes, a smaller 64-gallon cart is available upon request. Call B-Connected at (540) 908-4212 to request a smaller cart for your refuse needs.

Note for Businesses & BRC Residents

### How can the elderly and disabled be expected to handle such large carts?

Backdoor Waste Collection Service is offered for households solely occupied by persons with physical limitations or disabilities. This door-to-truck service comes at no additional expense. Call B-Connected at (540) 908-4212 to sign up for this service.

### What if my trash is missed?

Please call our B-Connected number at (540) 908-4212 and we will get in touch with WM to see if it is possible to get it picked up.

### How do I report a damaged or stolen cart?

Use that same B-Connected number (540) 908-4212. We will be able to get you on the replacements list for a new cart or a repair.

### Can I use my own trashcan or place a bag on the curbside for collection?

No, the automated arm of the truck can only lift and dump the carts provided by WM.

### If I move out, what do I do with my cart?

Leave it at the residence for the next homeowner. These carts are leased through Waste Management.

### How do holidays impact my trash collection?

The following holidays are observed by Waste Management: New Year's, Memorial Day, 4<sup>th</sup> of July, Labor Day, Thanksgiving, and Christmas. When a holiday falls on a collection day, service for that day and the following days of that week will be delayed by one day.

### What happens if there is bad weather on my collection day?

In the case of bad weather, Waste Management will decide whether they are able to collect trash as usual. If they decide to delay by a day, we will notify you as soon as possible through the Buzz at [bridgewater.buzz](http://bridgewater.buzz).

This information applies to Waste Management residential customers only. BRC residents served by the Town will receive a special version from BRC. For business customers, see [bridgewater.town/businesswaste](http://bridgewater.town/businesswaste).

## Sandy Bottom Recycle Center

### What do I do with recyclable materials?

Residents are responsible for taking their recyclable materials to the Recycle Center at 610 East College Street (Sandy Bottom Park). Once at the drop-off location, residents must present proof of residency (B-Rec card or Driver's License). Then, the items need to be placed into the appropriately labeled container. A staff member will be on-site to assist.

### When can I bring my recycling to the Recycle Center?

- Wednesday: 10:00 am – 4:00 pm
- Thursday: 10:00 am – 7:00 pm
- Friday: 10:00 am – 4:00 pm
- Saturday: 8:00 am – 12:00 pm

### What can I recycle?

We recycle many household items. We also have a device that will crush computer hard drives, SSD's, flash drives, phones, and chipped credit cards to HIPAA standards. Additionally we have a locked bin for depositing papers to be shredded. Stay posted by visiting at [bridgewater.town/recycle](http://bridgewater.town/recycle).

Recyclable Items	
Plastic #1	Office Paper
Plastic #2	Printer Cartridges
Plastic #5	Grocery Bags
Aluminum Cans	Hard Drives
Bi-metal Cans	Cell Phones
Newspaper	Glass Bottles
Cardboard	Batteries

### Who can recycle here?

Bridgewater residents only. For this reason, we ask that you present your B-Rec card or Driver's License upon arrival.

### How can I get my children involved in recycling?

Kids up to age 10 are encouraged to participate in their family's recycling efforts through the Recycler's Card program. For each trip they make to the Recycle Center, they receive a punch on their card. Ten trips complete a card. With their first completed card, they win a "Ben" t-shirt; the second entitles them to a "Corey" t-shirt, and the third, a "Dalyah" t-shirt. The fourth and final completed card wins a coveted spot on our Wall of Fame!



## Monthly Large Item Collection

### When are large items picked up?

Collection begins on the first Monday of the month at 7:00 am, and we need for your materials to be out at that time, but no earlier than the preceding Friday at 7:00 pm. Collection occurs throughout the week. If the first Monday is a holiday, collection will begin on Tuesday. Once items are picked up on your street, maintenance will not come back to pick up anything else. If you miss pick up, items must be removed from curb until next month or hauled away yourself.

### So what are the rules for large-item pick-up?

1. At any one stop, we will pick up no more than nine cubic yards of materials (measured without crushing or compressing). If you set out more than that, you will need to pull some back until the following month.
2. We don't accept hazardous materials or those which cannot be dumped at the landfill. Thus we won't pick up motor oil, insecticide, paint (unless it is dried out), animal carcasses, and the like. We also can't pick up tires, motor vehicles, lead acid batteries, or tree stumps.
3. Materials must be at the edge of the street.
4. Materials need to be sorted: metals (including appliances), furniture, tree limbs (no long than 8'), bagged vegetation, and household trash (too large for standard collection).
5. Grass clippings and leaves must be bagged, not in a trash can. Other vegetation must be stacked as neatly as possible, with branches no longer than eight feet.

### Why didn't you pick up my items?

If we decline to pick up something under our rules or the ordinance, we will leave you a note explaining why. This doesn't happen very often.

### There are ruts where I put out my large items.

Many large items require collection by heavy machinery. If items are on your grass, the machinery might do some damage to your yard. You will need to repair any ruts or other damage. (This doesn't happen very often, either.)

### Hazardous Waste

Bridgewater does not provide waste services for hazardous materials, but the county landfill holds hazardous waste collection days, typically in May and October. For more details, see [bridgewater.town/hazardouswaste](http://bridgewater.town/hazardouswaste).

